



Home > Products > ProX Truss > Extension Poles , Mounting Accessories > 40 inch Truss Mounting Pole Extension Pole for Mounting Stage Lighting and more

SKU: XT-DC40

Permalink: <http://www.proxdir.com>

[Search on Google](#)

40 inch Truss Mounting Pole Extension Pole for Mounting Stage Lighting and more

[Find A Dealer](#)

Product Images

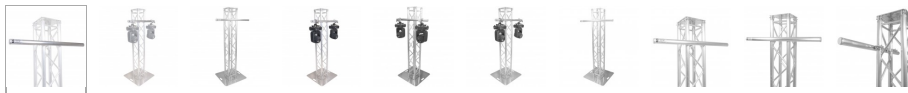

[Download Product Images](#)

Our Products And You

Submit your
story

XT-DC40 40 inch Truss Mounting Pole Extension Pole for Mounting Stage Lighting and more

Description

ProX **XT-DC40 40-inch Truss Mounting Pole Extension for Mounting Stage Lighting** and more. Presenting the ProX XT-DC40 — a revolutionary solution that provides an instantaneous and substantial extension to your mounting possibilities, specifically tailored for numerous heavy-duty DJ or stage lighting fixtures. With a generous span of 40 inches, this innovative apparatus empowers you to seamlessly affix it on two sides of your F34/F32 trussing in a singular stroke. Crafted meticulously from premium-grade aluminum, the XT-DC40 strikes an exquisite equilibrium between feathery-light composition and unwavering robustness. Its inherent versatility seamlessly harmonizes with its exceptional strength.

Meticulously engineered to accommodate any standard 2" disc jockey or stage trussing, the XT-DC40 unfurls a capacious and expansive display realm, awaiting the installation of a myriad of mountable fixtures. This ingenious augmentation transforms your trussing into a sprawling canvas, primed to showcase an array of lighting elements or embellishments. The fusion of durability, practicality, and adaptability renders the XT-DC40 an indispensable asset in the toolkit of discerning DJs, stage managers, and event professionals.

Dive into a realm where innovation knows no bounds — the ProX XT-DC40 stands as a testament to ingenuity, craftsmanship, and the relentless pursuit of elevating your lighting arrangement to unprecedented heights. It's not just an accessory; it's an embodiment of limitless creativity.

Features

- **Single 40-inch Mounting pole with Dual welded clamps**
- **Expands trussing space for heavy-duty lighting fixtures**
- **40" length for dual mounting on F34/F32 trussing**
- **Fits standard 2-inch F34 Truss Segments**
- **Creates spacious display area for various fixtures**

Exterior Dimensions & Weight

2.00"H x 2.00"W x 40.00"L - Weight: 4.00 lbs

Shipping Dimensions & Weight

Box 1 of 1: 3.00"H x 6.00"W x 41.00"L - Shipping Weight: 5.00 lbs

Our Products and You

Submit your
story

Commonly Asked Questions

+ Where can I buy one?

[submit a question](#)

Customer Testimonials

What did you think

Related Products

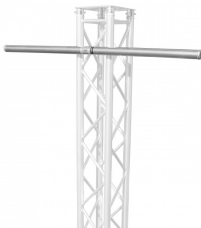

60" Pole 2" OD W/ Dual Welded Clamps for F34 F32 Trussing For Hanging Moving Head
SKU: XT-DC60



42-90" LED LCD Plasma TV Monitor Screen Display Mount for F34 F33 F32 F31 Bolted 12 inch Truss Segments
SKU: XT-PLASMA MK2

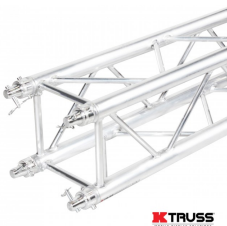

6.56 Ft. | 2M K-Truss F34 Economy Aluminum Truss for displays and non-load bearing systems
SKU: KT-F34SQ656



30" Aluminum 6mm Truss Base Plate for F34 F32 F31 Conical Square Truss with Connectors
SKU: XT-BP30AMK2
